

ELEVATION

SIDE VIEW

ISA-50 X 50

ISA-50 X 50

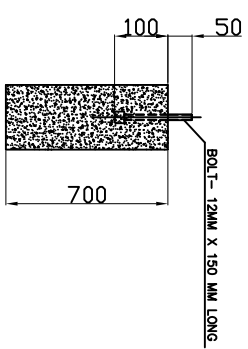

ELEVATION OF PILLER WITH BOLT IN THE CENTER OF MKD-\"R\"
(QTY - 08 Nos.)

F	E	K	L	M	N	O	I	P
2508	2508	2758	2758	627	1254	1098	549	1200

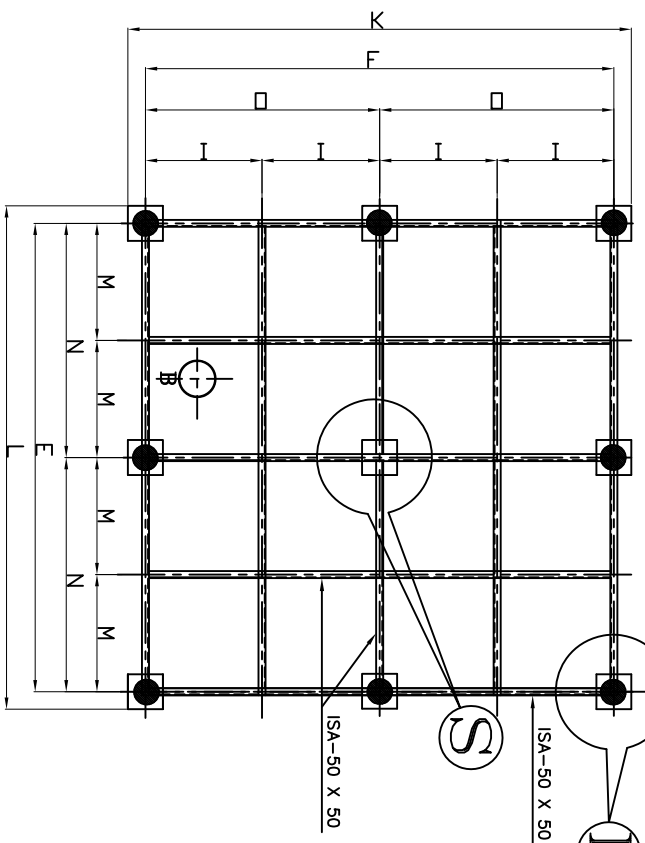

BASE FRAME

DISCRPTION	MARK	SIZES
INLET PIPE CONNECTION	A	125 X 2 Nos.
OUT LET PIPE CONNECTION	B	125 X 2 Nos.
DRAIN & OVERFLOW CONNECTION	C	50" EACH
MAKE UP AND QUICKFILL CONNECTION	D	40 EACH
LENGTH OF COOLING TOWER	E	2508
WIDTH OF COOLING TOWER	F	2508
FAN DIA AND NOS.	P	Ø1500 X 1 No.

NOTES:-

- ALL DIMENSIONS ARE IN MILLIMETERS UNLESS OTHERWISE STATED.
- COOLING TOWER WILL BE ASSEMBLED ON ISA FRAME FIXED ON RCC PILLAR THE FRAME IS UNDER PURCHASERS SCOPE.
- MAKEUP AND QUICKFILL CONNECTION TO BE PROVIDED WITH THREAD CONNECTIONS AS PER IS - 544-1955.
- INLET AND OUTLET CONNECTION TO BE PROVIDED WITHOUT FLANGE.
- RCC BASIN AND RCC PILLERS 250X250X700 HIGHT AND Ø12 X 150 LONG BOLTS ARE UNDER PERCHASER SCOPE.
- 10mm HOLE AT THE DISTANCE OF 5" ON THE PERIPHERAL OF ISA OF THE BASE FRAME SHALL BE PROVIDED BY PURCHASER.
- LOCATION OF OUTLET CONNECTION ACCORDING TO SITE REQUIREMENT.
- Ø12X150 LONG BOLTS SHALL BE GROUTED IN THE CENTRE OF OUTER COLUMNS AS SHOWN IN THE DRAWING.
- 9 ALL ISA (ANGLES ON PERIPHERAL WILL FACE OUTSIDE I.e.T .**

DELTA COOLING TOWERS P. LTD.

SITE: -

DES.	DRN	CHKD	APPD
	Langul	By-6-12	

G.A OF DRG. OF COOLING TOWER MODEL NO.6125 SERIES- DFC 60

JOB NO. _____ REV-0