

ELEVATION

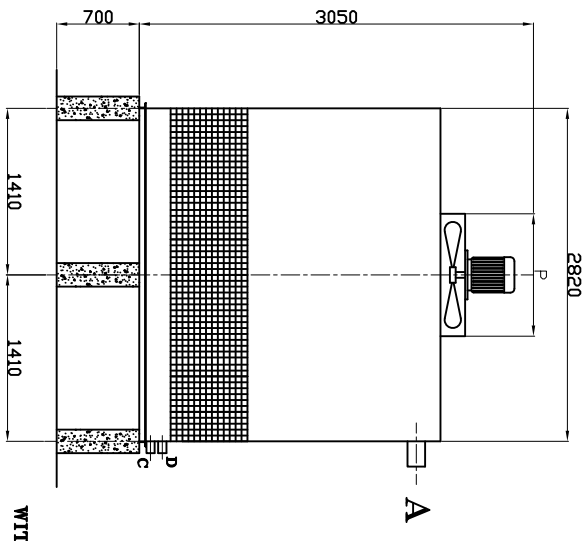

SIDE VIEW

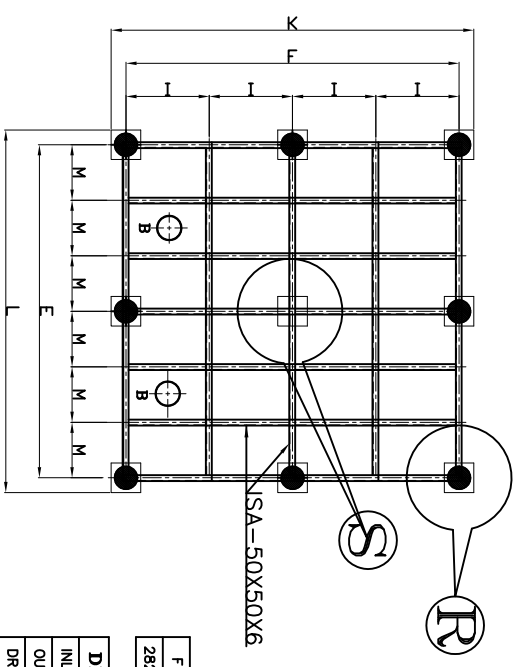
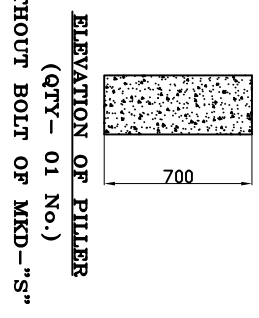

BASE FRAME

ELEVATION OF PILLER WITH BOLT IN THE CENTER OF MKD-"R" (QTY- 08 Nos.)

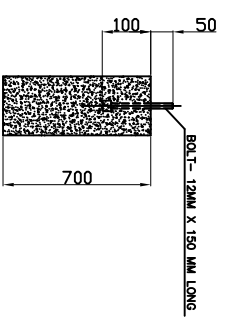

DESCRIPTION	MARK	SIZES
INLET PIPE CONNECTION	A	125 X 2 NOS
OUT LET PIPE CONNECTION	B	125 X 2 NOS
DRAIN & OVERFLOW CONNECTION	C	50 EACH
MAKE UP AND QUICKFILL CONNECTION	D	40 EACH
LENGTH OF COOLING TOWER	E	3126
WIDTH OF COOLING TOWER	F	2820
FAN DIA AND NOS.	P	Ø1500 X 1 No.

NOTES:-

- 1 ALL DIMENSIONS ARE IN MILLIMETERS UNLESS OTHERWISE STATED.
- 2 COOLING TOWER WILL BE ASSEMBLED ON ISA FRAME FIXED ON RCC PILLAR THE FRAME IS UNDER PURCHASER'S SCOPE.
- 3 MAKEUP AND QUICKFILL CONNECTION TO BE PROVIDED WITH THREAD CONNECTIONS AS PER IS - 544-1955.
- 4 INLET AND OUTLET CONNECTION TO BE PROVIDED WITHOUT FLANGE.
- 5 RCC BASIN AND RCC PILLERS 250X250X700 HIGHT AND Ø12 X 150 LONG BOLTS ARE UNDER PERCHASER SCOPE.
- 6 10mm HOLE AT THE DISTANCE OF 5" ON THE PERIPHERAL OF ISA OF THE BASE FRAME SHALL BE PROVIDED BY PURCHASER.
- 7 LOCATION OF OUTLET CONNECTION ACCORDING TO SITE REQUIREMENT
- 8 Ø12X150 LONG BOLTS SHALL BE GROUTED IN THE CENTRE OF OUTER COLUMNS AS SHOWN IN THE DRAWING.
- 9 ALL ISA (ANGLES ON PERIPHERAL WILL FACE OUTSIDE 1eT .

DELTA COOLING TOWERS P. LTD.
G.A DRG. OF COOLING TOWER MODEL NO. 6175
 SERIES- DFC 60
 SCALE NOT TO SCALE
 JOB NO. _____ REV-0