

Front View

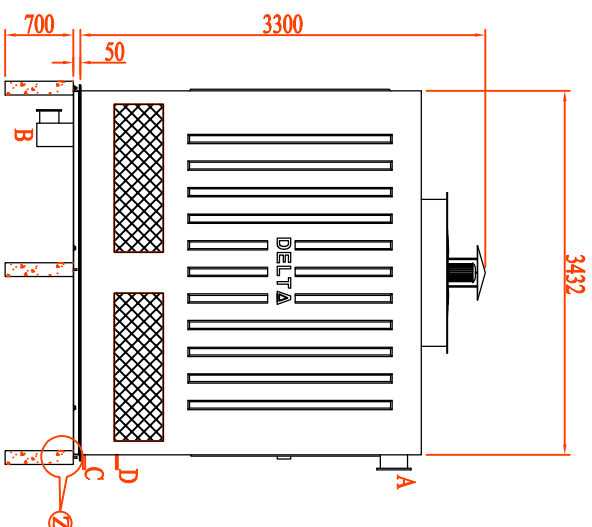

Side View

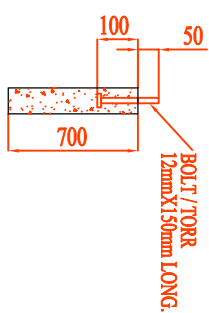
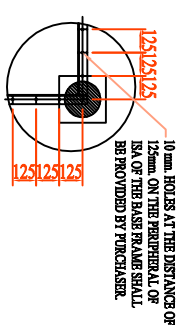

ELEVATION OF PILLER WITHOUT BOLT OF MKD - "R" (QTY - 8 NOS.)

ALL PERIPHERAL ISA (ANGLES) SHALL BE FACED OUTSIDE.

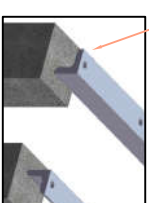

ELEVATION OF PILLER WITHOUT BOLT OF MKD - "S" (QTY - 1 NO.)

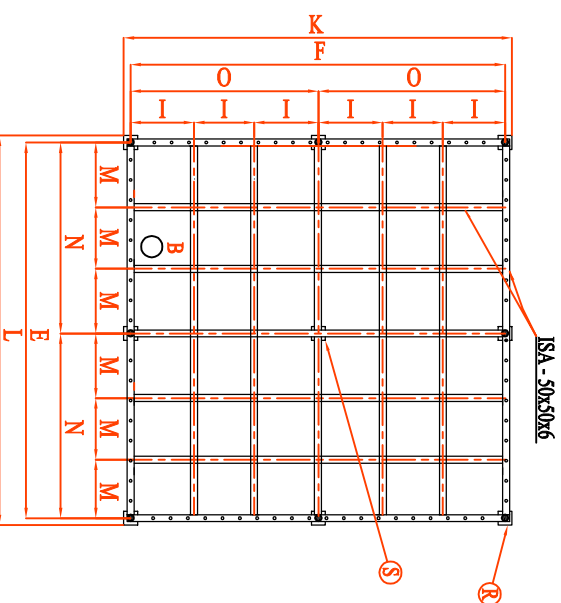

Base Frame

Notes:-

1. All dimensions are in millimeters.
2. Cooling tower will be assembled on is-50x50x6 frame fixed on RCC pillar the frame is under purchasers scope unless otherwise stated.
3. Makeup and quickfill connection shall be provided with thread connections as per is-544-1955.
4. Inlet & outlet connection shall be provided without flange.
5. RCC basin and RCC pillars 250x250x700 ht. And  $\phi 12 \times 150$  long bolts/tor are under purchaser scope.
6. 10 mm hole at the distance of 125mm on the peripheral of ISA of the base frame shall be provided by purchaser.
7. Location of outlet connection will be as per the site requirement.
8.  $\phi 12 \times 150$  long bolts/tor shall be grouted in the centre of outer columns as shown in the drawing.
9. All pictures shown are for illustration purpose only and may differ from the actual cooling tower model.

E	F	K	L	M	I	N	O	P
3738	3432	3682	3988	623	572	1869	1716	1200

DESCRIPTION	MARK	SIZES
INLET PIPE CONNECTION	A	150X 2 NOS.
OUTLET PIPE CONNECTION	B	200 X 1 NO.
DRAIN & OVERFLOW CONNECTION	C	50 EACH
MAKEUP AND QUICKFILL CONNECTION	D	25 EACH
LENGTH OF COOLING TOWER	E	3738
WIDTH OF COOLING TOWER	F	3432
FAN DIA AND NOS.	P	$\phi 1200 \times 2$ Nos.
OPERATING WEIGHT (KG.)		3600

NOT TO SCALE / DO NOT SCALE DRAWING	DWG NO.:-
TITLE:	G.A OF DRG. OF COOLING TOWER MODEL NO. 6250
COMPANY:	SERIES - DPC 60
	Delta Cooling Towers P. Ltd
	Delhi
SITE:	(PH - 011-2749380/0203) EMAIL - mail@delta.coil
Design@delta.com	REV :- 12/2017